

Notes:

- LC(BF) Termination procedure see document: ETP-1909-001 Senko Blown Fibre Connector Termination Procedure
- Stripping method 'Option A' is preferred for these samples (Option A method see Termination procedure).
- Connector endface appearance inspection standard: Senko level 2
- 3D Geometry/Interferometer inspection standard: Senko level 2
- All connectors should have protective dust caps.
- On LC/APC Blown fiber connector, the Plug Frame, Extender Cap & Boot not be shown as fitted to the cable assembly, they should be separate in a zip seal bag.
- Packing spec:
 - Image shows a reel design for holding the blown fibre assemblies.
 - End B is fitted to a furcation, and is contained within a chamber area within the cardboard reel.
 - Standard test data sheet to be needed.
 - Pack 1x item 5 & 6 and cable assembly together.
- Compliance: RoHS

REVISIONS			
REV.	DESCRIPTION	DATE	REVISED
1.0	DRAWING ISSUED	2023.8.24	Chris Li



Below 3 parts should be separate in a zip seal bag, and will be shipped with patchcord.

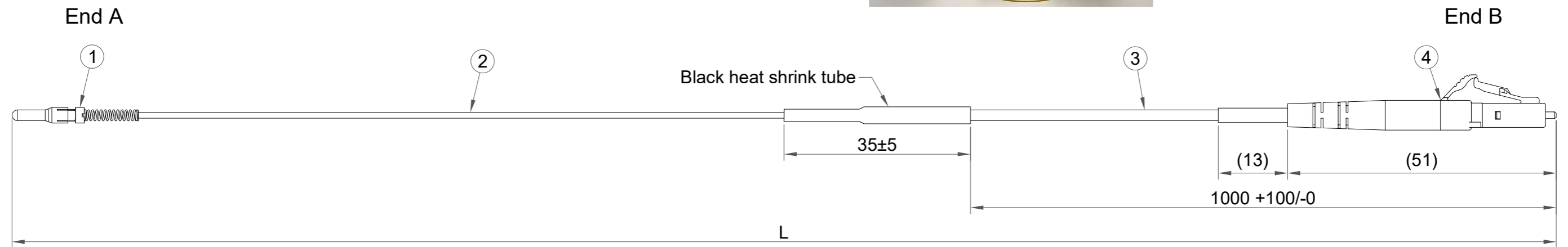
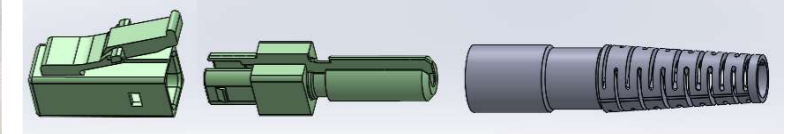

Optical Specification

Fiber Type	Singlemode	
Polish Type	LC/APC (BF)	LC/APC (Grade B)
Insertion Loss (dB)	≤ 0.3	≤ 0.15
Return Loss (dB)	≥ 65	≥ 65
Test Wavelength (nm)	1310 & 1550	

Length (L)	Length Tolerance
L < 1m	+50mm/-0
1m ≤ L ≤ 10m	+100mm/-0
L > 10m	+1%*L/-0

The blown fiber connector consists of the components shown below

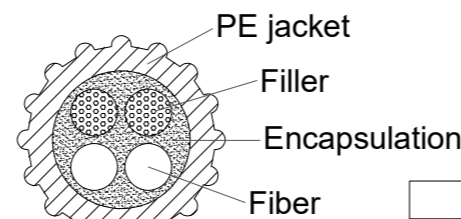
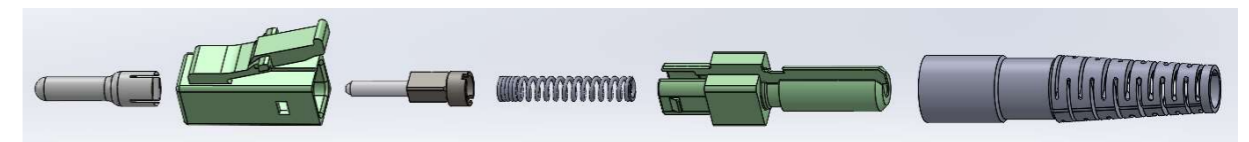

Cable Profile View

CONFIDENTIAL

Information on this document is proprietary and may not be used, copied, reproduced, or disclosed without the written consent of SENKO Advanced Components, Inc.

Category M

UNLESS OTHERWISE SPECIFIED:
DEBURRS ALL SHARP EDGES,
DIMENSIONS ARE AFTER FINISH

TOLERANCES:
0 - 5 mm =
5 - 30 mm =
30 - 120 mm =
120 - 300 mm =
∠ =

Item No.	Part Number	Description	Qty.
6	ENC-1022-1822	Nitrile Extruded Tubing, OD6.3, ID3.95, L24	1
5	ENC-1022-1821	HDPE Extruded Tubing, OD4.1, ID3.6, L1500	1
4		LC APC Standard Connector, Green Housing, 2.0mm Green Boot, APC Ferrule	1
3		2.0mm Yellow LSZH Tube with Kevlar and 900um Hytrel Tube	1
2		1.1mm 2F Yellow Blown Cable, Corning SMF-28e+ BB (G.657.A1) Fiber, (only one fiber is used, the other fiber is cut at the encapsulation point)	1
1	9G1-153-361	LC SX BLOWN FIBER CONNECTOR ASSEMBLY	1

Drawn By ENG.DEPT.	Checked By Chris Li	All Dimensions in mm	Date 2023.8.24	Scale Free
Name: LCAPC(BF)-LCAPC 1.1mm 1F G.657.A1 Yellow Blown Fiber Jumper		PN: Dwg.No: ENC-0823-1597		
			Rev. 1.0	Sheet 1/1

Core Position Should be Meet IEC 61755-3-2

The tuning is must to do for sure core position
Ferrule grade select:
- 0.6um concentricity for Grade B
- Ferrule ID should be 125.2~126.2

Eccentricity of core (Grade B)

Ref.	APC		Remarques
	Min	Max	
G	0	0.3	Radius, um
F	0	1.0	Radius, um
H	0	50	Degrees